

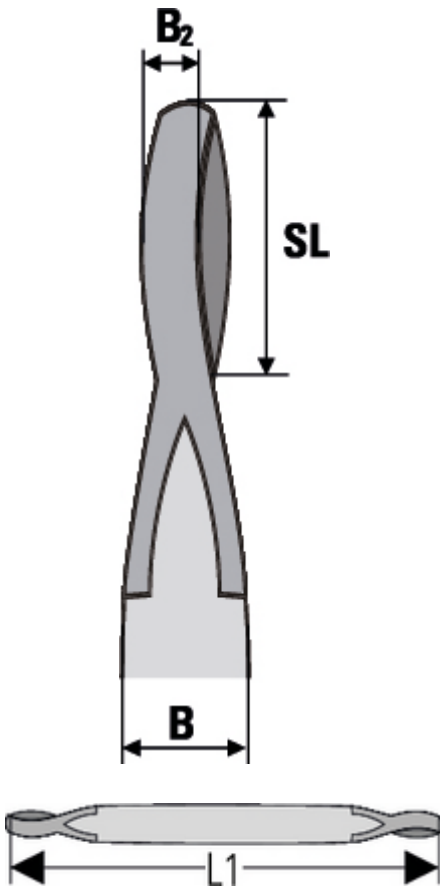

PowerForce with D1 Links

Ideal for construction & mechanical engineering, they handle sharp edges ($\geq 2\text{mm}$) without extra protection, ensuring safety and longevity



Item Name short	Colour	Dimension L1 [m]	WLL kg [kg]	WLL t [t]	Webbing Width B [mm]	Weight Net [kg]	Weight for 1m [kg]
PowerForce 1ply D1D1 1000 2m	Purple	2	1000	1	40	1.14	0.57
PowerForce 1ply D1D1 2000 2m	Green	2	2000	2	80	1.86	0.93
PowerForce 1ply D1D1 3000 2m	Yellow	2	3000	3	120	3.16	1.58
PowerForce 1ply D1D1 1000 3m	Purple	3	1000	1	40	1.22	0.57
PowerForce 1ply D1D1 2000 3m	Green	3	2000	2	80	2.02	0.93
PowerForce 1ply D1D1 3000 3m	Yellow	3	3000	3	120	3.4	1.58
PowerForce 1ply D1D1 1000 4m	Purple	4	1000	1	40	1.3	0.57
PowerForce D1D1 2000 4m	Green	4	2000	2	80	2.18	0.93
PowerForce 1ply D1D1 3000 4m	Yellow	4	3000	3	120	3.64	1.58
PowerForce 1ply D1D1 1000 5m	Purple	5	1000	1	40	1.38	0.57
PowerForce 1ply D1D1 2000 5m	Green	5	2000	2	80	2.34	0.93
PowerForce 1ply D1D1 3000 5m	Yellow	5	3000	3	120	3.88	1.58
PowerForce 1ply D1D1 1000 6m	Purple	6	1000	1	40	1.46	0.57
PowerForce 1ply D1D1 2000 6m	Green	6	2000	2	80	2.5	0.93
PowerForce 1ply D1D1 3000 6m	Yellow	6	3000	3	120	4.12	1.58
PowerForce 1ply D1D1 1000 8m	Purple	8	1000	1	40	1.62	0.57
PowerForce 1ply D1D1 2000 8m	Green	8	2000	2	80	2.82	0.93
PowerForce 1ply D1D1 3000 8m	Yellow	8	3000	3	120	4.6	1.58



PowerForce (D1D1)

Subject to technical changes. All rights reserved. No part of this Technical Data Sheet may be reproduced in any form (print, photocopy, microfilm or any other process) or processed, duplicated or distributed using electronic systems without the written permission of SpanSet. This Technical Data Sheet has been prepared with due care; SpanSet accepts no liability for errors or omissions. © SpanSet (UK) Limited - United Kingdom

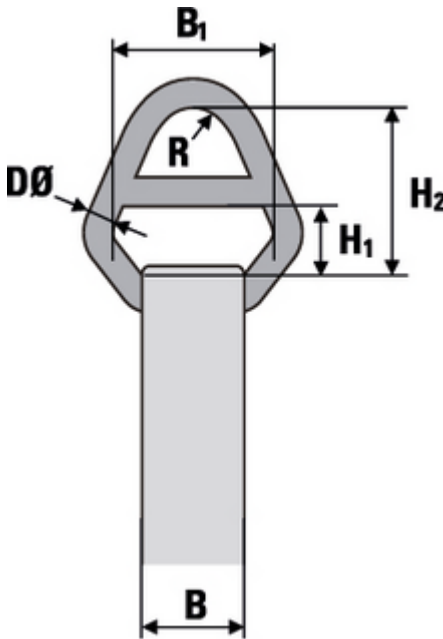
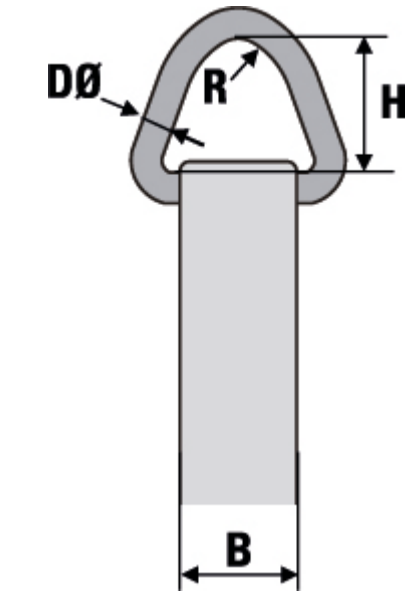

Item Name short	Weight per Meter [kg/m]
PowerForce 1ply D1D1 1000 2m	0.08
PowerForce 1ply D1D1 2000 2m	0.16
PowerForce 1ply D1D1 3000 2m	0.24
PowerForce 1ply D1D1 1000 3m	0.08
PowerForce 1ply D1D1 2000 3m	0.16
PowerForce 1ply D1D1 3000 3m	0.24
PowerForce 1ply D1D1 1000 4m	0.08
PowerForce D1D1 2000 4m	0.16
PowerForce 1ply D1D1 3000 4m	0.24
PowerForce 1ply D1D1 1000 5m	0.08
PowerForce 1ply D1D1 2000 5m	0.16
PowerForce 1ply D1D1 3000 5m	0.24
PowerForce 1ply D1D1 1000 6m	0.08
PowerForce 1ply D1D1 2000 6m	0.16
PowerForce 1ply D1D1 3000 6m	0.24
PowerForce 1ply D1D1 1000 8m	0.08
PowerForce 1ply D1D1 2000 8m	0.16
PowerForce 1ply D1D1 3000 8m	0.24



PowerForce (D1D1)

Subject to technical changes. All rights reserved. No part of this Technical Data Sheet may be reproduced in any form (print, photocopy, microfilm or any other process) or processed, duplicated or distributed using electronic systems without the written permission of SpanSet. This Technical Data Sheet has been prepared with due care; SpanSet accepts no liability for errors or omissions. © SpanSet (UK) Limited - United Kingdom

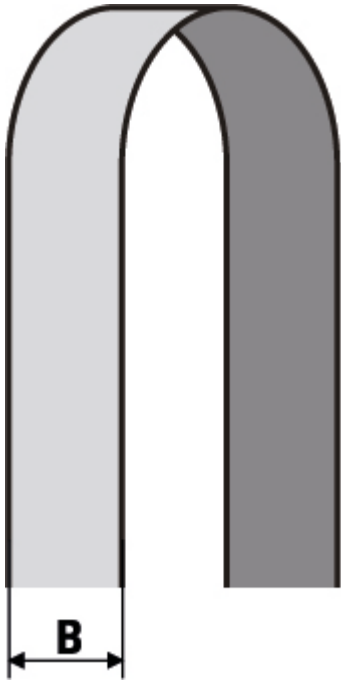

ORDER NUMBERS

Dimension L1	1000	2000	3000
2	2002975	2002976	2002977
3	2003448	2003450	2003452
4	2003449	2003451	2003453
5	2003946	2003949	2003952
6	2003947	2003950	2003953
8	2003948	2003951	2003954

- **Main Material** High molecular weight polyethylene (HMPE)
- **Webbing Thickness** 3 mm
- **Temperature Range** -40°C bis +60°C
- **Quality** professional
- **Label Protection** Yes

SpanSet (UK) Limited
Telford Way Middlewich
Cheshire CW10 0HX
United Kingdom
Tel.: +44 (0) 1606
737494
info@spanset.co.uk
www.spanset.co.uk



PowerForce (D1D1)

Subject to technical changes. All rights reserved. No part of this Technical Data Sheet may be reproduced in any form (print, photocopy, microfilm or any other process) or processed, duplicated or distributed using electronic systems without the written permission of SpanSet. This Technical Data Sheet has been prepared with due care; SpanSet accepts no liability for errors or omissions. © SpanSet (UK) Limited - United Kingdom

**SpanSet
Certified
Safety**

■ Packaging Unit (PU) Content 1



PowerForce (D1D1)

Subject to technical changes. All rights reserved. No part of this Technical Data Sheet may be reproduced in any form (print, photocopy, microfilm or any other process) or processed, duplicated or distributed using electronic systems without the written permission of SpanSet. This Technical Data Sheet has been prepared with due care; SpanSet accepts no liability for errors or omissions. © SpanSet (UK) Limited - United Kingdom